

Configuration

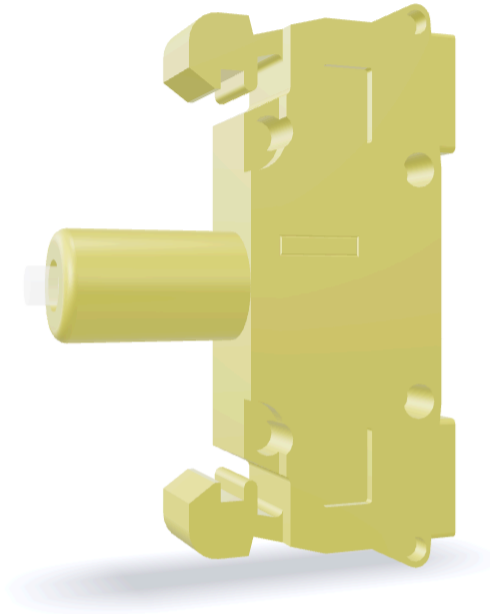

Find Activators



Watchlist

Technical data

Product images

Configuration:

MKPLED24W

Lamp module with ultra-bright LED and push-in connection

Operating Temperature	-40 ... 70°C
Storage Temperature	-50 ... 85°C
Electrical Life	40.000 h
Illumination	Yes
Series	Kontaktgeber MK...
Connection Type	Push-In
Protection Class Front	IP20

CONTACT

THE COMPANY

INFORMATION

Application portal

