

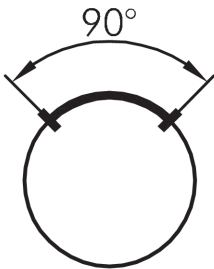

Selector head, maintained RMCWAL

Description: inclusive four small transparent colour plates in red, yellow, green and blue

Category: Selector switches (momentary/maintained)
 Series: RONDEX-M
 Panel cut-out: $\varnothing 22.3$ mm
 Protection class: II (protective insulation)
 Degree of protection: IP65
 Switching function: maintained action
 Illumination: yes
 With labelling option: no
 Front bezel: metallic/charcoal
 Shape: round

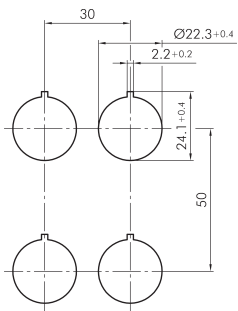
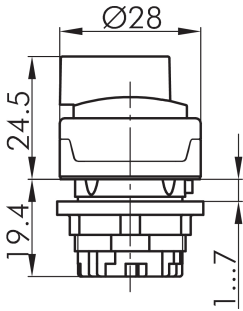

Legend

**I = Switching position > =
Spring return**