

Watchlist

Technical data
Product images
Downloads

Configuration:

RXJSSA12E

Key actuator, maintained

Series	RX-JUWEL
Class of Protection	II (protective insulation)
Switching Function	Latching function
Protection Class Front	IP65
Switching Position	-90° key removal 90° key removal 0° key removal
Shape	round
Mounting Aperture	Ø 22,3mm
Front Bezel Color	charcoal
Illumination	

TECHNICAL SKETCHES

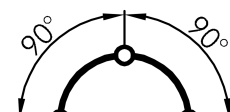
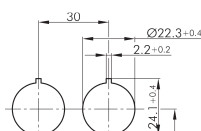
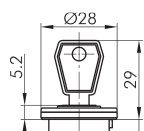

This website uses cookies to ensure the best experience possible. [More information...](#)

<b>AZVN</b>	
Contact block, momentary	
Approbations	DNVGL , cCSAus , CCC , ENEC05 , CE , KEMA , UKCA
Mechanical Life	1.000.000 switching cycles
	24V DC IEC/EN 60947-5-1
	250V DC IEC/EN 60947-5-1
	60V DC IEC/EN 60947-5-1
	125V DC IEC/EN 60947-5-1
	240V AC IEC/EN 60947-5-1
Rated Operating Voltage	
Switching Function	Momentary function
Class of Protection	II (protective insulation)
Storage Temperature	-50 ... 85°C
Contact Type	1NC + 1NO
Series	Contact blocks AZ...
Operating Temperature	-30 ... 70°C
Connection Type	flat-plug connections
Protection Class Front	IP00
Operating Travel	6mm
Electrical Life	1.000.000 switching cycles

**TECHNICAL SKETCHES**

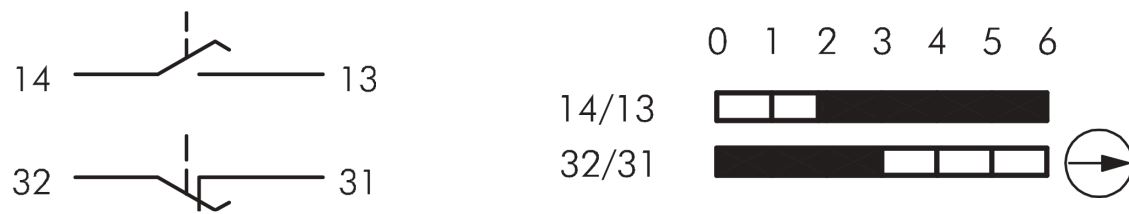

**CONTACT**

**THE COMPANY**

**INFORMATION**

[Application portal](#)