

STLRYI_C005

25.11.2021

Pushbutton with ring illumination and 4-pole M12 connector



General Data

| | |
|------------------------------|--|
| Type reference | STLRYI_C005 |
| Description | Illuminated short-stroke pushbutton with integrated contact block and M12 connection |
| Approvals | CE, cURus, ENEC10, VDE, UKCA |
| Contact type | 1 NO |
| Degree of protection | IP65 / IP67 |
| Operation travel | 2.3 mm (pushbutton) |
| Connection type | 4-pole M12 connector (integrated), A coded |
| Contact material | AgNi |
| Max. storage temperature | -40°C ... 80°C |
| Max. operating temperature | -25°C ... 70°C |
| Mechanical life | 1 million switching cycles |
| Electrical life (rated load) | 1 million switching cycles |
| Contact resistance NO | < 50 mOhm (new state) |
| Bouncing time NO | < 10ms |

Electrical data acc. to IEC/EN 60947-5-1 (VDE 0660 Sect. 200)

| | alternate current | direct current |
|-----------------------------|-------------------|----------------|
| Utilisation category | AC15 | DC13 |
| Rated insulation voltage Ui | 50 V | 50 V |
| Rated operating voltage Ue | 35 V | 35 V |
| Rated operating current Ie | 4 A | 2 A |
| Breaking capacity | - | - |
| Continuous thermal current | 4 A | - |

Technical Data - Lamp

| | |
|-------------------|--------------------------------------|
| Lamp socket | none, with integrated 3 mm LED white |
| Max. lamp voltage | 30 V AC/DC |
| Max. lamp output | 14 mA (at 24 V DC) |



Additional data

| | |
|-----------------------------------|--------------------------|
| Mounting aperture | 22.3 mm |
| Tightening torque (mounting nut) | 1.5 ... 1.9 Nm |
| Tightening torque (M12-connector) | max. 0.4 Nm |
| Mounting position | any |
| Standards | EN 60947-5-1, EN 61058-1 |
| Material group | I |
| Overvoltage category | II |
| Pollution degree | 2 |

Note

I = NO contact

- pushbutton with yellow illuminated ring
- silver-coloured

Pin assignment:

Pin 1 Pin 2 Pin 3 Pin 4 Type

NO NO LED - LED + 1 NO + LED

Safety instructions / mounting instructions

- the connector must not be connected or disconnected under load
- the single connector pin may be loaded with max. 4 A

Test data acc. to UL60947-5-1 / C22.2 No. 60947-5-1

| | |
|-------------|--------------------------|
| Rating | 24VDC 2A general purpose |
| Lamp rating | 30 Vac/dc, 14 mA max |



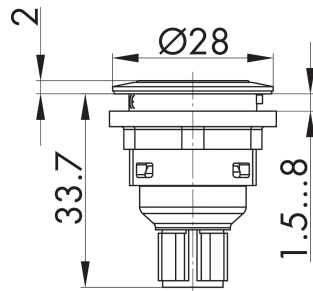

PIN 1/ PIN 2

